

MEDesign® Ltd Backfriend® Spares

INSTRUCTIONS FOR FITTING REPLACEMENT HINGES

Push the fixing lugs through the eyelet in the seatbase and refit the hingelock ***ensuring that the hinge is at the front of the backrest.***

The hinges normal service life is at least 12 months but premature failure can be caused by:

a) Compressing the Backfriend in a folding car seat; b) Letting the seat base “flop” down when opening; c) “Falling” down into the Backfriend. Avoiding the above, plus reasonable care, will help to ensure a long life for the hinge.

INSTRUCTIONS FOR FITTING HINGELOCK - N.B. Fit Hinges into seatbase first

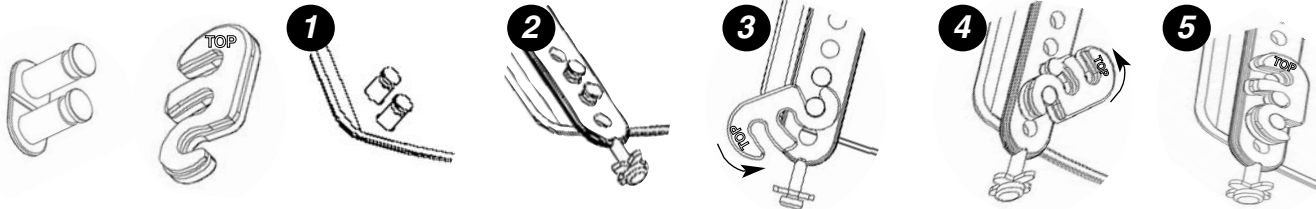

INSTRUCTIONS FOR FITTING REPLACEMENT VELCRO

Remove the worn velcro from the Backfriend and then use a 2 part, epoxy adhesive such as Araldite to fix the new pieces in place. Or, please contact us for details if you would prefer us to re-rivet new Velcro.

To help ensure long life of your Backfriend, replace hinges, hingelocks and velcro as soon as necessary.

Full details on all MEDesign products are available at www.medesign.co.uk

MEDesign® Ltd, Clock Tower Works, Railway Street, Southport, Merseyside, PR8 5BB, England.
Telephone: (01704) 542373 Fax: (01704) 545214 Website: www.medesign.co.uk E-Mail: postbox@medesign.co.uk